



Building on the Cornerstone

CCS
“The Blueprint” Capital Campaign



Building on the Cornerstone

CCS “The Blueprint” Capital Campaign

Dear Family and Friends of Cornerstone Christian School:

It is with great joy and excitement that we are officially announcing our long-anticipated capital campaign to construct new facilities to meet the needs of Cornerstone Christian School. From its founding in 1992, Cornerstone Christian School (CCS) has been changing the lives of students in Laurel County and the surrounding area by educating and equipping them with a distinctly Christian education. The ministry of CCS has realized many successes including obtaining and maintaining ACSI accreditation, assembling a well credentialed certified Christian faculty and most importantly impacting hundreds of former and current students by providing a Christian education with a biblical worldview. While we are proud of these achievements, we know God has much more in store for the future of our school. To fulfill our purpose and reach our potential CCS must reach beyond our successes and find solutions to the challenges we face.

For the last three years the Board of Directors and faculty has been prayerfully involved in strategically planning for what lies ahead for CCS. Each area of our school has been thoroughly assessed to identify strengths, weaknesses, opportunities and threats. This process has resulted in an aggressive five-year strategic plan casting vision for our school in all areas including facilities. Developing adequate facilities has proven to be one of the most consistent barriers CCS has faced to sustain growth and development. In 2017 Cornerstone Christian School was approached by Souls Harbor Church who had a strong desire to support Christian education in our community. A partnership between Souls Harbor and CCS developed and has proven to meet one of the greatest needs in the history of our school by providing CCS a long-term home with a campus on which the school can develop needed facilities.

Cornerstone Christian School moved to the Souls Harbor Campus in the summer of 2019 after making minor accommodations to the existing facilities. In our first year in our new home CCS enrollment grew by nearly 20%. Over the last 15 months our school has continued to experience unprecedented growth and the favor of God. Our classes are full and we are now out of space. Work on a master plan for future facilities began in 2019 as the board conducted a design charette with an architect and contractor evaluating options for future growth and development. The results are the following master plan that we believe will meet both the urgent needs of our school as well as provide for future growth and development. These plans are the result of much prayer as we realize that unless the lord builds the house, its builders labor over it in vain (Psalm 127:1). We are proud to present the following master plan to our school constituency consisting of three phases.

These three phases combine to form an ambitious plan for the future of CCS. We believe God is calling us to pursue great things in the ministry of Christian education. As Ephesians 3:20 reminds us God is able to do exceedingly abundantly more than we ask or think!!! Imagine the impact CCS will have in the lives of our students, families, community and most importantly the Kingdom of God. The need for Christian education has never been greater. It is imperative that we teach our children of the love of Jesus, the wonderful plan of salvation and a biblically sound worldview all while providing excellence academically. We ask that you prayerfully consider partnering with us financially to support CCS as we endeavor to grow our school for the glory of Jesus. Attached are different levels and opportunities for phase one of our campaign. If you would like more detailed information or would like to meet with us to discuss any questions please feel free to contact us.

Sincerely,

Joe Allen
Principal

John Miller
Board Chairman

CCS Blueprint PHASE 1: Urgent Needs

Phase 1 of our Master Plan will consist of the conversion of the existing Port Building to a classroom building. The new classroom building will house our elementary school on the first floor and our middle/high school on the second floor. Our preschool program will be relocated to the lower level of the auditorium where the elementary school is currently located.



Benefits of Phase 1 will include:

- Over 12,000sf of new or renovated space
- Increased enrollment capacity
- Larger more comfortable updated classrooms for all students
- Designated areas with support spaces for preschool, elementary and middle/high school

Desired Timeline of Phase 1:

- October 2020 – Contracted with Deco Architects to complete architectural drawings, obtain necessary permits
- November 2020 – Begin Capital Campaign with goal of raising \$1,000,000
- January 2021 – Selection of Contractor
- March 2021 – Begin Construction
- August 2021 – Complete Construction for 2021-2022 School year

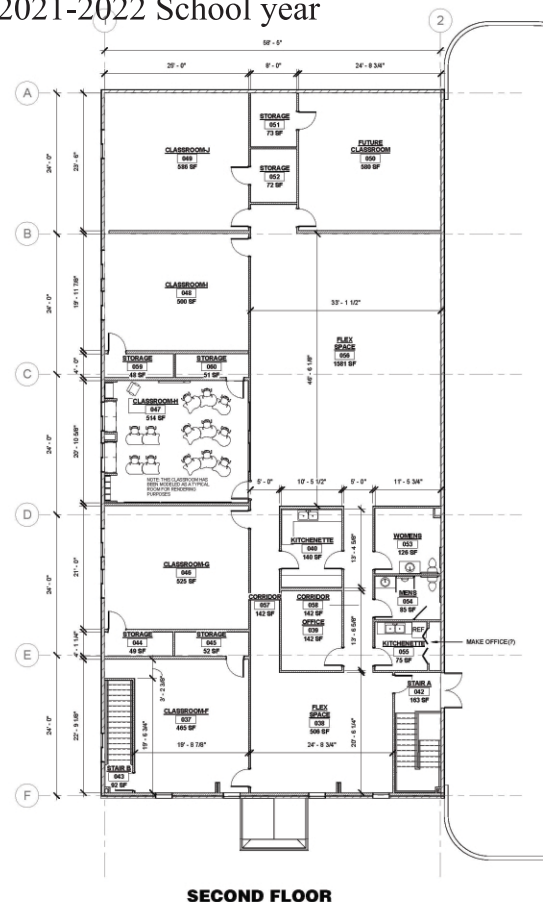
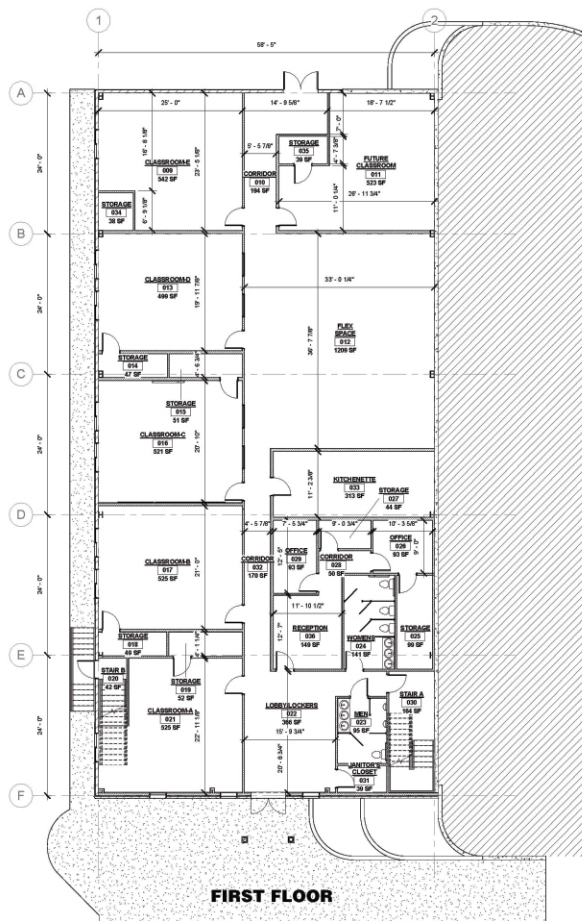

CCS Blueprint PHASE 2: Bringing it all together

Phase 2 of our Master Plan will consist of the construction of a new building which will connect the existing Port Building and Auditorium Building. This new structure will provide a full regulation size gymnasium as well as additional support spaces.

Benefits of Phase 2 will include:

- Over 18,000sf of new space
- All facilities will be connected improving efficiency, security, daily flow
- Addition of a full regulation size gymnasium with locker rooms and bleachers
- A new school entrance with designated drop off area
- Additional office space
- Additional classrooms for specials (library, computer, music, art, etc.)
- Increased enrollment capacity

Desired Timeline of Phase 2:

- September 2021– Contract with Architecture firm to complete Phase 2 architectural drawings and obtain necessary permits
- October 2021 – Continuation of Capital Campaign with goal of raising \$2,000,000
- January 2022 – Selection of Contractor
- Summer 2022 – Begin Construction
- Summer 2023 – Complete Construction





CCS Blueprint PHASE 3: Continued Growth

The completion of Phases 1 and 2 of our master plan will allow us to accommodate approximately 300 students. We believe CCS will continue to grow and prosper during each phase. To continue to grow and develop we feel the next step will be to construct a new building to house Middle/High School with plans to begin constructing an athletic complex.

Benefits of Phase 3 will include:

- A new separate facility to house a growing Middle/High School
- Development of an athletic complex
- Increased enrollment capacity

Desired Timeline of Phase 3:

- Fall 2023 – Selection of site for new Middle/High School and athletic complex
- Spring 2024 – Contract with Architecture firm to complete Phase 3 architectural drawings
- Fall 2024 – Continuation of Capital Campaign
- January 2025 – Determine Construction timeline

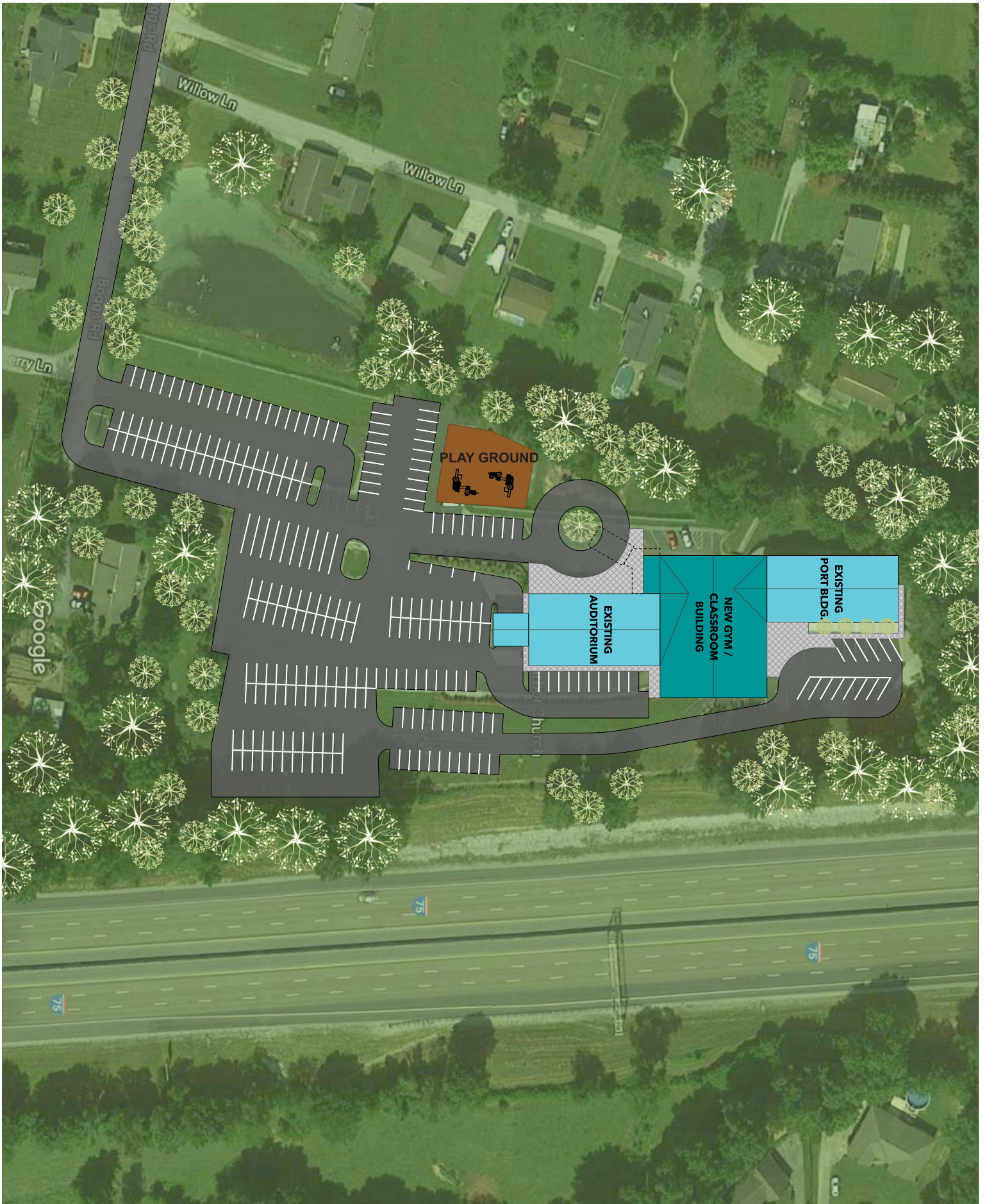



Phase 1 Goal \$1,000,000

CCS Blueprint Phase 1 Donation Levels:

PLEASE MARK YOUR CHOICE BELOW

- | | |
|---|-----------|
| <input type="radio"/> Cornerstone Level | \$100,000 |
| <input type="radio"/> Eagle Level | \$50,000 |
| <input type="radio"/> Classroom Sponsor Level | \$25,000 |
| <input type="radio"/> Purple Level | \$10,000 |
| <input type="radio"/> Gold Level | \$5,000 |
| <input type="radio"/> Silver Level | \$1,000 |
| <input type="radio"/> White Level | \$500 |

NAME: _____

ADDRESS: _____

PHONE: _____

DONATION LEVEL/AMOUNT: _____

Please Check One ☐ One time Gift ☐ Monthly Installments (Up to 6 Installments)

Ways to give:

- › Check - Return this form by mail or to the school office with Check made payable to CCS Building Fund
- › Cash – Return this form with Cash to school office
- › Credit Card/PayPal – Online at www.cornerstoneky.com or in the school office
- › ACH Deduction from Account (up to 6 monthly Installments)
- › Stocks/Capital Gains – Contact us for more information

Thank you for partnering with us in the ministry of Christian Education! If you have questions or need more information regarding CCS please contact us at 606.862.0509.

After completing your commitment form above, please remove this page along the perfed edge. Return it to the school office or mail via USPS .

70 Souls Harbor Way, London, KY 40744

PO Box 848, London, KY 40743 Phone 606-862-0509 Fax 606-862-4902 Email: Info@cornerstoneky.com

www.cornerstoneky.com

REMOVE ALONG PERF ↓